

# ILFORD

## SPRITE 35-II USER MANUAL

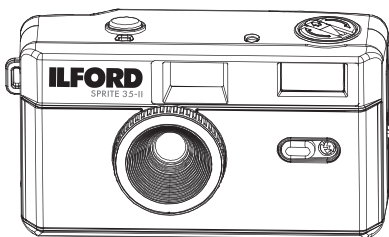

For product specifications and warranty information visit – [www.ilford.com](http://www.ilford.com)

ILFORD and the ILFORD Logo are registered trademarks of ILFORD Imaging Europe GmbH.

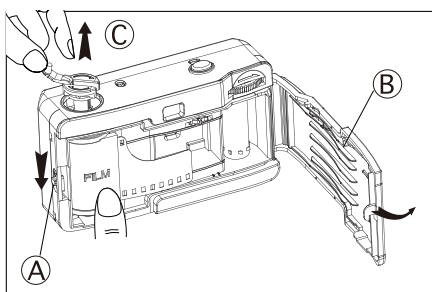

### HOW TO LOAD FILM (STEP 1)

Press the latch [A] in the direction of the arrow and open the camera back door [B]. Lift the camera rewind crank [C] and place a new roll of film into the chamber.

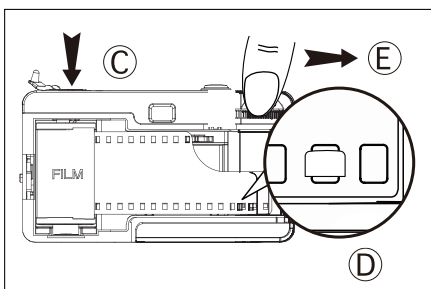

### HOW TO LOAD FILM (STEP 2)

Push the rewind crank [C] back into place. Pull out the film canister and hook the 2nd hole onto the film take-up spool [D]. Slightly advance the film by turning the film advance wheel [E].

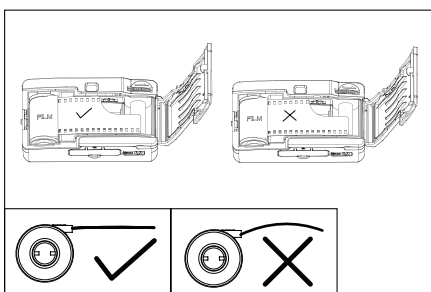

### HOW TO LOAD FILM (STEP 3)

Ensure the film lays flat against the centre of the camera and close the back door.

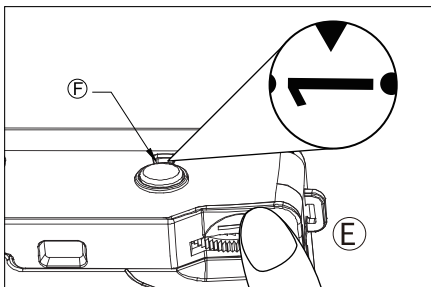

### HOW TO LOAD FILM (STEP 4)

Continue to advance the film by turning the film advance wheel [E] until it stops. Press the shutter button. Repeat the process one more time. The film counter [F] will now show number '1', and the camera is ready for taking pictures

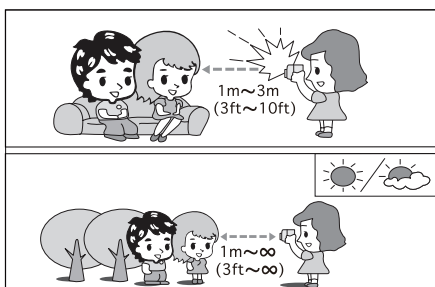

## HOW TO SHOOT PHOTOS

For best results, stand at least 1 metre from the subject and take photos in sunny or partly sunny weather. When taking pictures, keep the sun at your back.

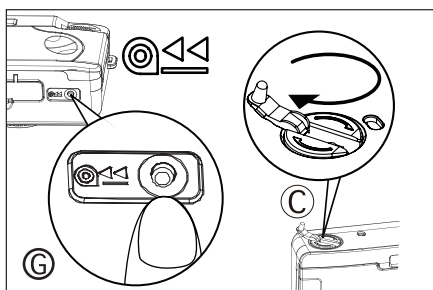

## HOW TO REWIND THE FILM (STEP 1)

After all the pictures are taken press the rewind button [G] located at the bottom of the camera. Turn the film rewind crank [C] clockwise until all the film is re-wound back into the film canister.

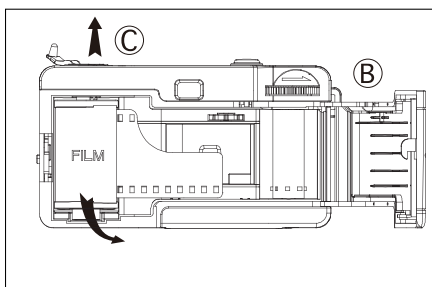

## HOW TO REWIND THE FILM (STEP 2)

Open the camera back door [B], lift up the film rewind crank [C], and remove the film for processing.

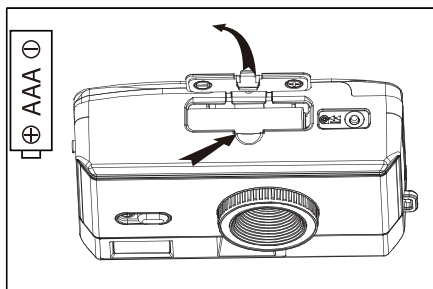

## HOW TO INSERT BATTERY (FLASH)

Open the battery door in the direction of the arrow. Insert one “AAA” battery into the battery chamber. Make sure the battery is inserted according to the correct polarity [“+” “-”].

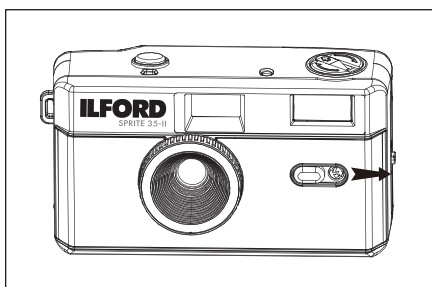

## HOW TO USE FLASH

Switch the flash Button to the “ $\frac{1}{2}$ ” position. Wait for the Flash Ready LED to glow. Once the Flash Ready Light glows, the flash is ready for taking pictures.